

Installation Instructions – EX® SignalTight™ 6 & 59 series



1 Cut cable squarely.



2 Using a fixed blade, prep tool in good condition, prepare cable to 1/4" x 1/4" dimensions. Use edge of tool if no stop

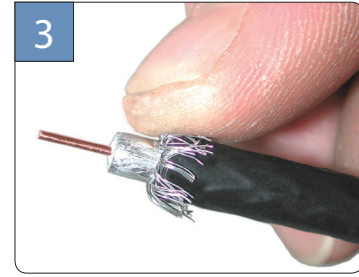

3 Fold back braid. If Trishield or Quadshield remove additional foil layer and fold back remaining braid.

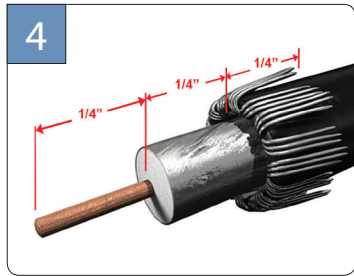

4 Cable is prepared to proper dimensions.

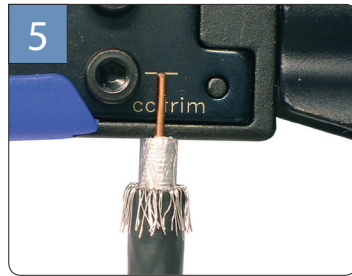

5 Ensure cable is prepared to 1/4" x 1/4" dimensions. Use gauge on VT tool to recheck center conductor.



6 Guide center conductor and dielectric into post. Insert cable into connector until dielectric is flush within post.

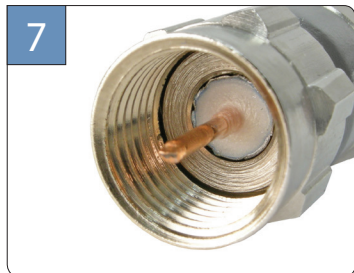

7 Dielectric is flush within the post.

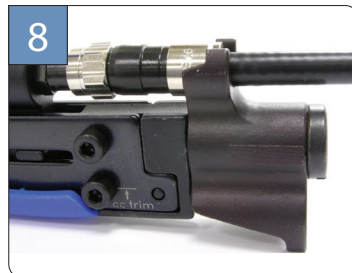

8 Properly seat connector and compress fully.



9 Tighten connector to recommended torque.

EX6PLUS



EX6XLPLUS



EX59PLUS



EX59XLPLUS



Part Numbers

- EX6PLUS
- EX6XLPLUS
- EX59PLUS
- EX59XLPLUS

Description

EX® SignalTight™ Series Universal compression connectors for 6 & 59 series cable